

Specification

Electrical rating	1~50mA/5~16VDC, 40T85, 300,000 cycles
Mechanical Life	500,000 cycles
Contact Resistance:	500mΩ max. (initial)
Operating Force:	150gf Max.
Insulation Resistance	100 MΩ min.
Dielectric Strength	500VAC for 60 +/- 5 sec
Housing	UL94 HB



IP Protection

Series	Actuation Side	Terminal Side	OF	OP
MQS-9B	IP 67	IP 00	50 - 150 gf	7.1±0.25mm

Ordering Instruction

Series	1	A	D	01	-	01
MQS-9B						
Electrical rating						
1= 1~50mA/5~16VDC, SPST NO						
2= 1~50mA/5~16VDC, SPST NC						
Location Pin						
A = Side L, 2mm						
B = Side R, 2mm						
C = Both Sides, 2.0mm						
D = Side L, 5.0mm						
E = Side R, 5.0mm						
F = Both Sides, 5.0mm						
N = No Location Pin						
G = Both Sides, 1.5mm						
Terminal Type						
A=Angled PCB pins, side L						
B=Angled PCB pins, side R						
C=Straight PCB pins						
D=Solder terminal						
E=Interlock terminal, side L						
F= Interlock terminal, side R						
G= Interlock terminal						
P= Interlock2 terminal, side L						
Q= Interlock2 terminal, side R						
R= Interlock3 terminal, side L						
T= Interlock3 terminal, side R						
W=Wires Specification: eg. W1, W2, W3, etc						
Lever Type						
00, 01, 02, 03 ... (00 = No lever) (01= 1# lever、02=2# lever、Custom-made:03,04,etc.)						
Version						
Standard Version: 01						
Custom-made:02,03,04,etc.						

Basic Dimensions

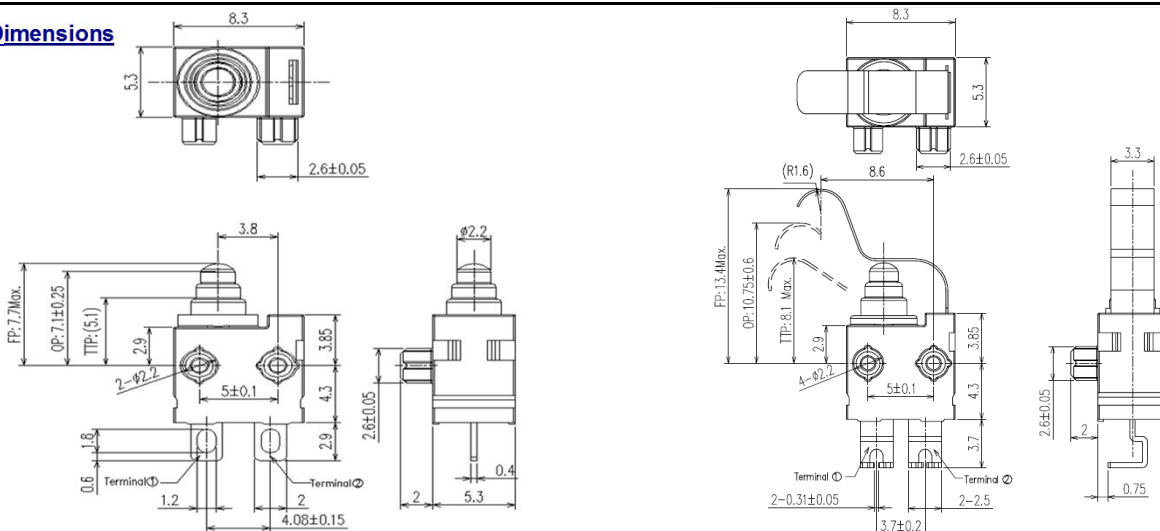

Common Characteristics

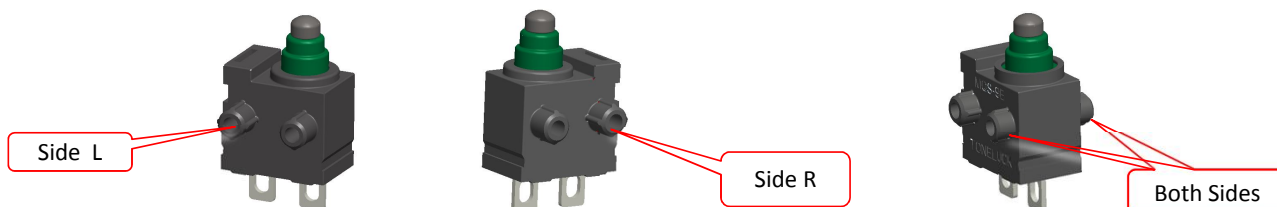

Circuit

MQS-9BXXXX-XX

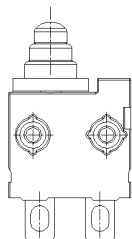

COM NC/NO

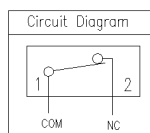
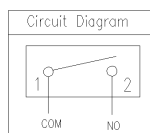

Lever type

Type 01: 1# Lever

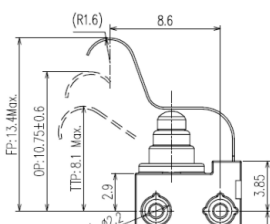

Type 02: 2# Lever

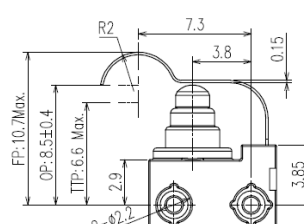

Terminal type

Type D: Interlock terminal

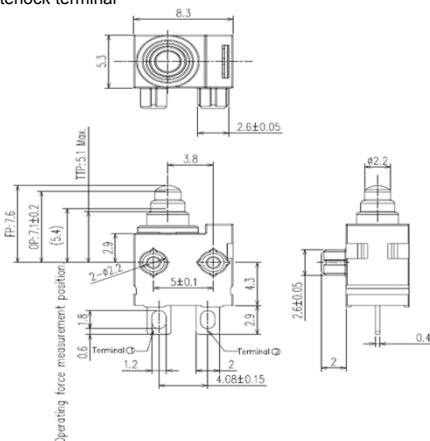

Type R: Interlock terminal

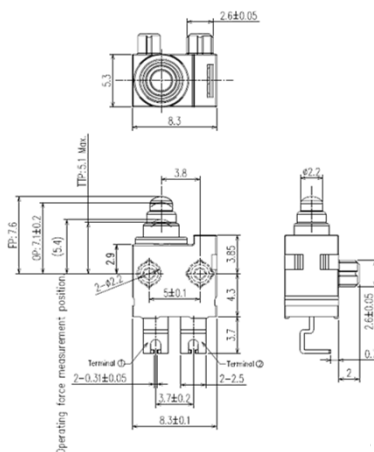

Actuation Angle

Besides actuating the micro-switch vertically, the switch could be operated by cam-shaped or chamfered sliding actuators with an approximate value of max. 40°. Please refer to the technical specification for the specified conditions.

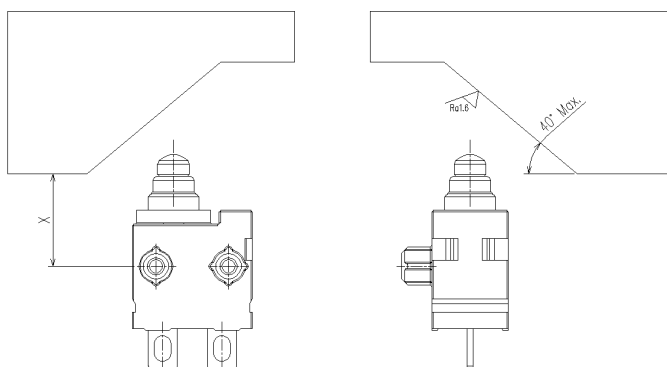

The approximate value of 40° was tested under the following conditions:

- Chamfered sliding material: POM.
- Polished chamfered sliding surface, greased with lubricant oil.
- Operation frequency : 30 cycles per minute.
- Operating travel until permissible end position measure "X" (see switch drawing).